

# Promultis Indoor SMD Series: P1.25 - P3.91 LED Video Walls

The Promultis SMD LED Video Wall comes in pixel pitch sizes from 1.25mm to 3.91mm, to account for a range of different viewing distances.

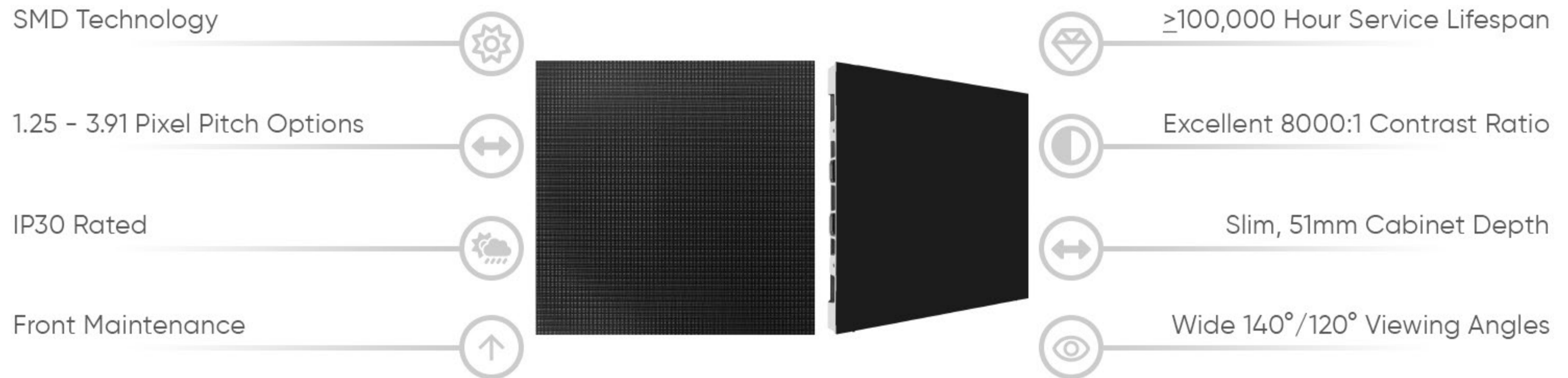

Note: Product design specifications including dimensions are subject to change without notice and may vary from those shown. Please call us for the most up to date specifications and dimensions.



[promultis]



For more exciting multitouch products visit  
[www.promultis.info](http://www.promultis.info)  
or call +44 (0) 239 251 2794

	P1.25	P1.56	P1.95	P2.6	P2.97	P3.91
Pixel Structure	SMD 1R1G1B, GOB Selectable					
Pixel Density (dot/m <sup>2</sup> )	640,000	409,600	262,144	147,456	112,896	65,536
Module size (W*H) (mm)	250*250	250*250	250*250	250*250	250*250	250*250
Backshell Material	No Backshell					
Module Resolution (W*H) (dot)	128*128	160*160	128*128	96*96	84*84	64*64
Maximum Current (A)	7	7	7	7	7	7
Supply Voltage (V)	5	5	5	5	5	5
Scanning Method	1/50	1/40	1/32	1/32	1/28	1/16
Refresh Frequency (Hz)	≥3840					
Illumination (cd/m <sup>2</sup> )	600 ~ 700					
Driver IC	Constant Current Drive					
Contrast Ratio	≥8000:1					
CABINET PARAMETERS						
Cabinet Size (W*H*D)	500*250*51 / 500*500*51 / 1000*250*51 / 1000*500*51					
Cabinet Material	Die Casting Aluminium					
Cabinet Weight (KG)	4.3/6.4/8.9/11.5					
Enclosure Connection Method	Screw Fixing					
Installation/Maintenance Methods	Front and Rear Installation / Front Maintenance					
Colour Temperature/Luminance Uniformity	3200K~9300K: ≥98%					
Chromatic Uniformity	±0.003Cx, Cy					

Note: Product design specifications including dimensions are subject to change without notice and may vary from those shown. Please call us for the most up to date specifications and dimensions.



[promultis]



For more exciting multitouch products visit  
[www.promultis.info](http://www.promultis.info)  
 or call +44 (0) 239 251 2794

Horizontal / Vertical View	$\geq 140^\circ / \geq 120^\circ$
Single-Point Colour Correction	Available
Single Point Brightness Correction	Available
Standard Receiver Card	A5S-PLUS
Frame Rate (Hz)	50/60
Protection Level	IP30
Signal Interface Mode	RJ45
Power Interface Mode	Three Pole Connector
Input Voltage Range AC (V)	100-240
Peak Power Consumption (W/m <sup>2</sup> )	$\leq 620$
Avg. Power Consumption (W/m <sup>2</sup> )	$\leq 310$
Working Temperature & Humidity Range	-20°C ~+50°C, 10% ~ 95%RH
Storage Temperature & Humidity Range	-40°C ~+50°C, 10% ~ 95%RH
Service Life (H)	$\geq 100000$
Mean Time Between Failure (H)	$\geq 10000$

Note: Product design specifications including dimensions are subject to change without notice and may vary from those shown. Please call us for the most up to date specifications and dimensions.



[promultis]



For more exciting multitouch products visit  
[www.promultis.info](http://www.promultis.info)  
 or call +44 (0) 239 251 2794

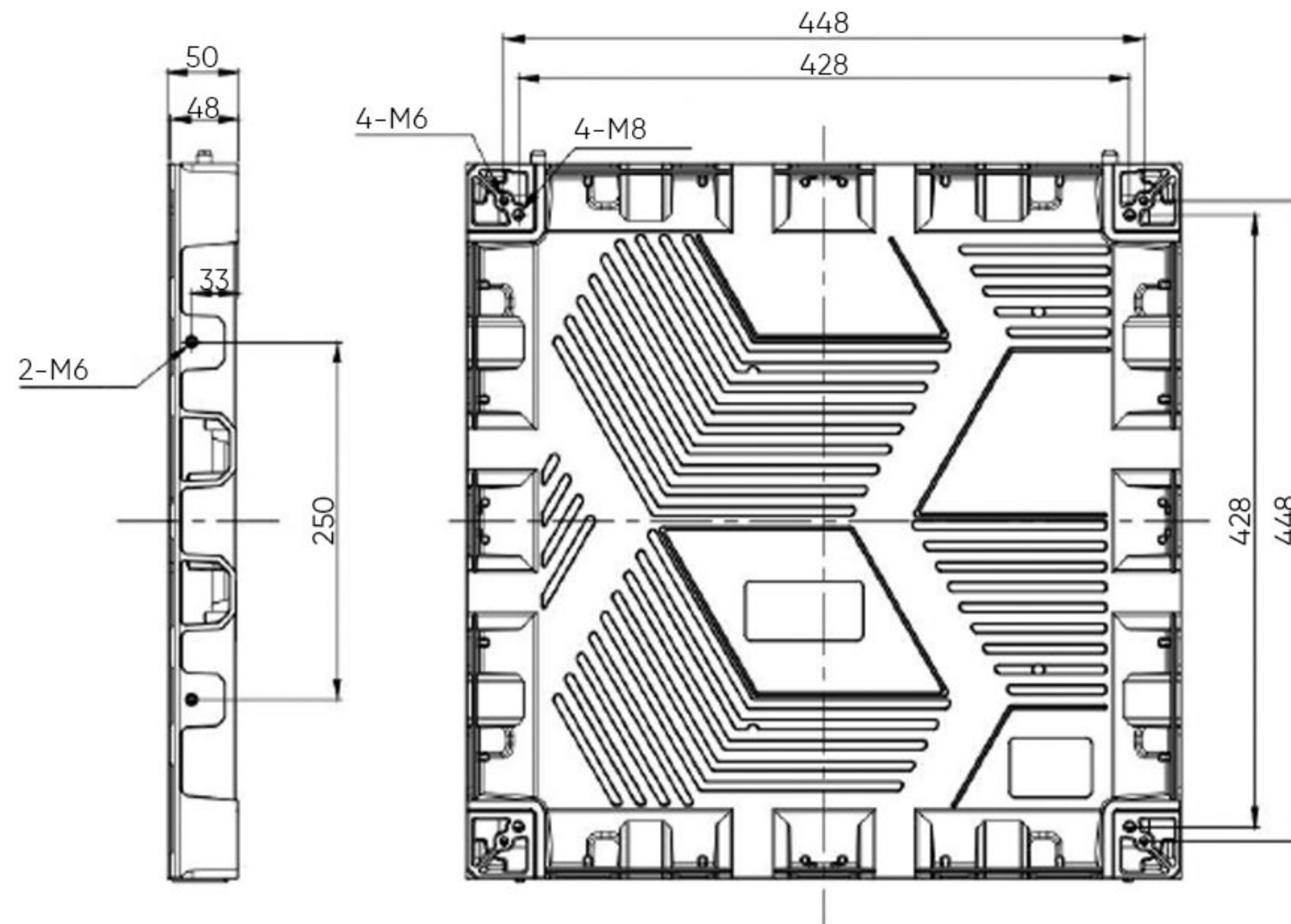

Note: Product design specifications including dimensions are subject to change without notice and may vary from those shown. Please call us for the most up to date specifications and dimensions.



[promultis]



For more exciting multitouch products visit  
[www.promultis.info](http://www.promultis.info)  
 or call +44 (0) 239 251 2794

# Optical features

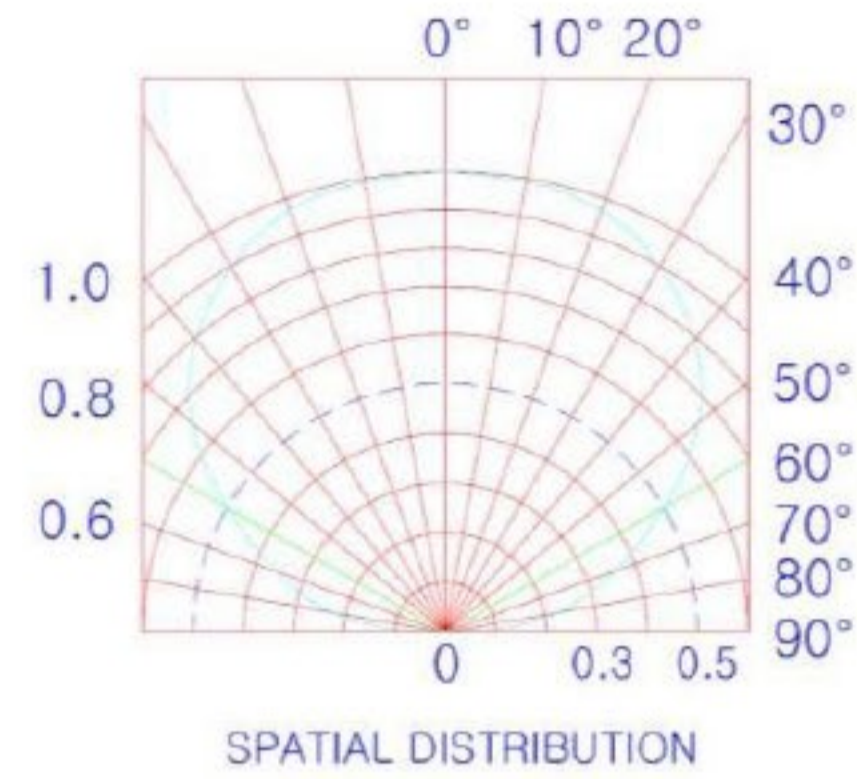

Luminous Diagram



Voltage-current Curve of Lamp

# Connecting diagram

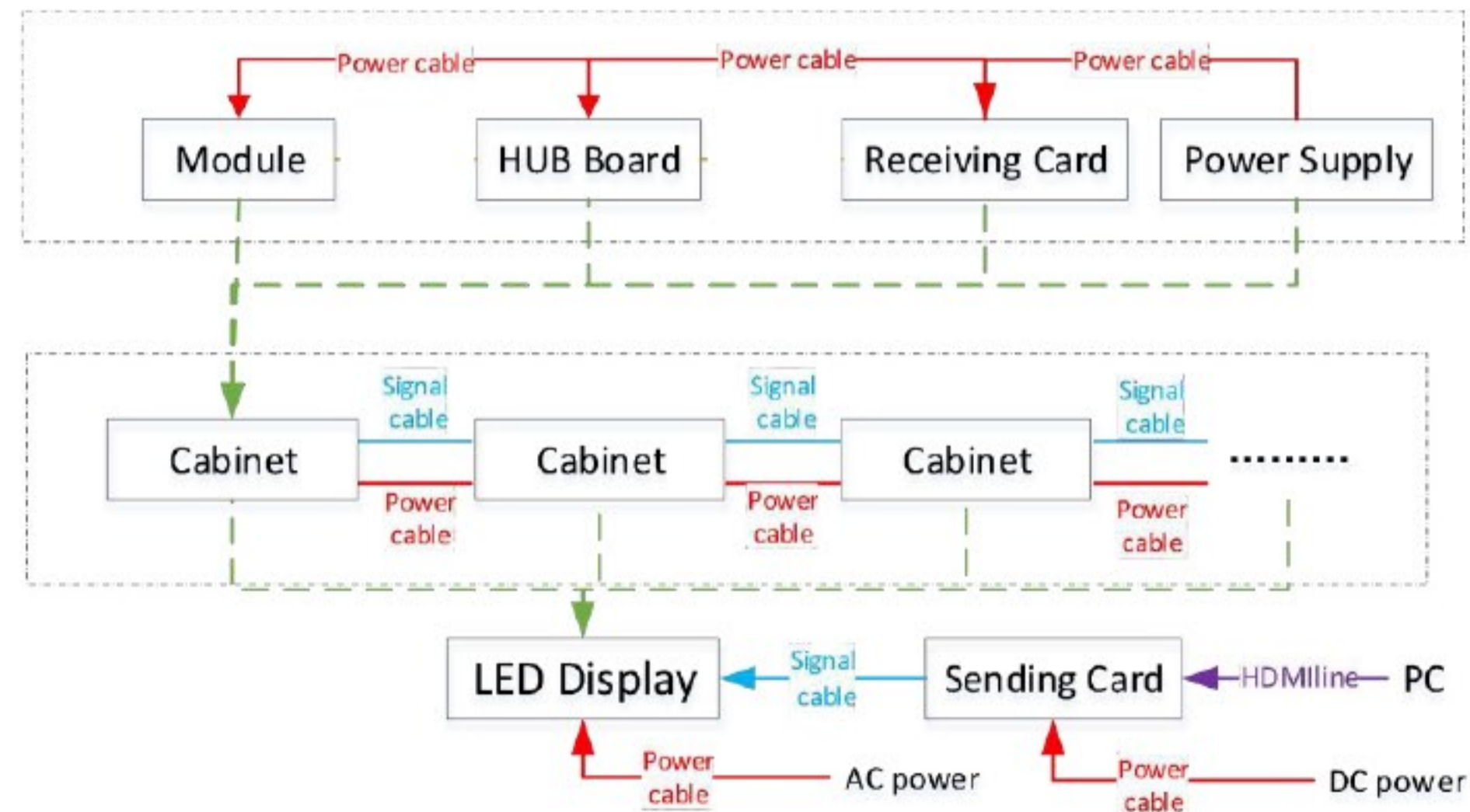

[promultis]



For more exciting multitouch products visit  
[www.promultis.info](http://www.promultis.info)  
or call +44 (0) 239 251 2794

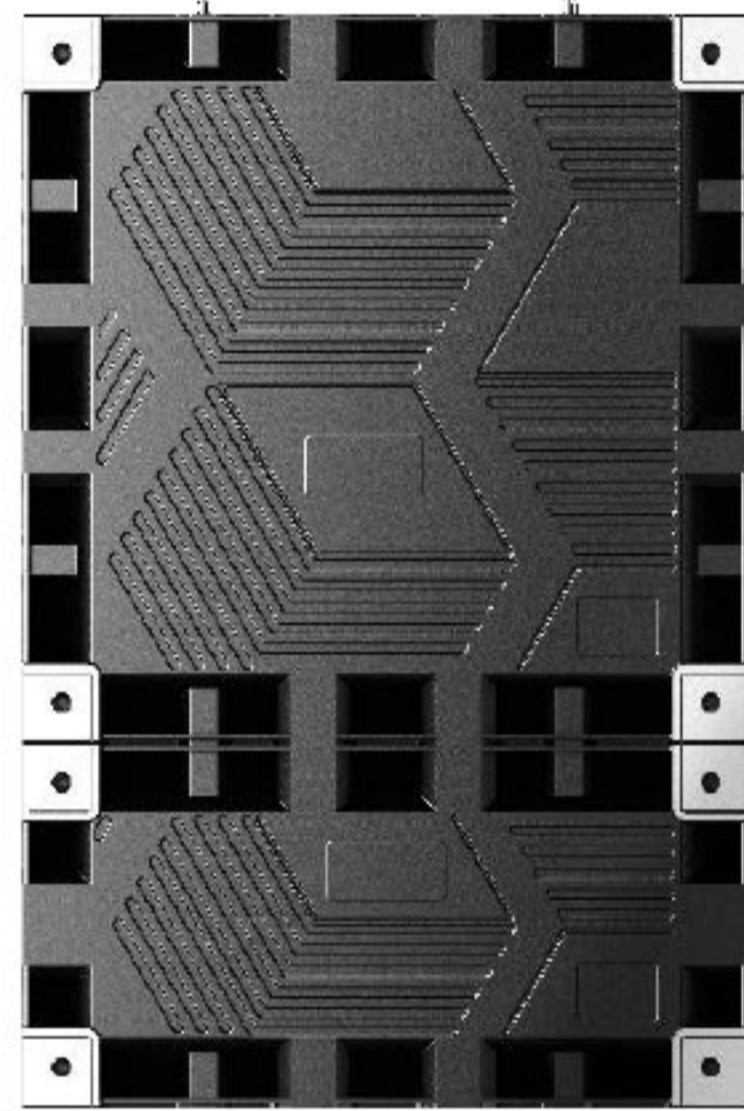

**Multiple Sizes Mixed**



**90° LED Screen**



**[promultis]**



For more exciting multitouch products visit  
[www.promultis.info](http://www.promultis.info)  
or call +44 (0) 239 251 2794